

ColorFlex® L2 Tomato Quick Start Guide

A60-1021-531 ver. 2.0

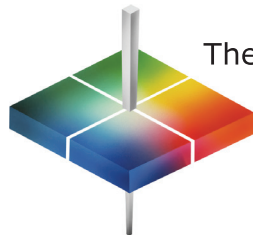

The world's true measure of color

HunterLab

A SETTING UP THE INSTRUMENT

1. Connect the plug on the AC adapter to the port on the back of the ColorFlex L2 Tomato.



2. Plug the power cord on the AC Adapter into a wall outlet.
3. Turn on the ColorFlex L2 Tomato using the switch on the back of the instrument.
4. The Essentials software will launch automatically and prompt First Time Setup dialog to setup Languages, Region, Date and Time. Click **DONE** when finished.
5. After the setup above, a Welcome Wizard will be prompted to introduce its features. Please follow the prompts to familiarize yourself with the software. Once completed, your instrument will be ready for standardization. You can always click the HunterLab icon in the top right corner to run the Wizard again.
6. (Optional) Connect a monitor to the ColorFlex L2 Tomato using an HDMI cable.

B TOMATO LICENSE ACTIVATION

1. Attach the flash drive with the Tomato license file to the ColorFlex L2 Tomato. Essentials will automatically recognize the license file in the flash drive and prompt a dialog. Click **ENABLE** to load the ColorFlex L2 Tomato Essentials.

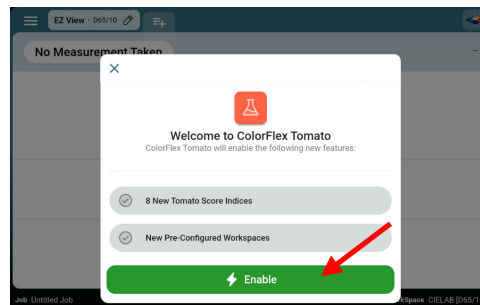

C HITCH CONFIGURATION

1. Tap **SETUP HITCH** green action button on the bottom of the screen. Follow the on-screen prompts to standardize first, then read the Tomato tile to complete the hitch setup.

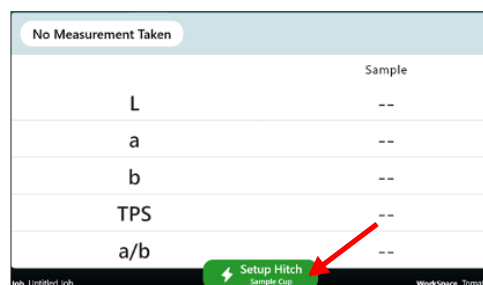

D STANDARDIZATION

1. Install the sample cup port plate. Place the Reflectance Black Glass at the sensor port. Press the **MEASURE** button.



2. When prompted, remove the Reflectance Black Glass and place the Instrument Standard (White Tile) on the port. Press **MEASURE**.

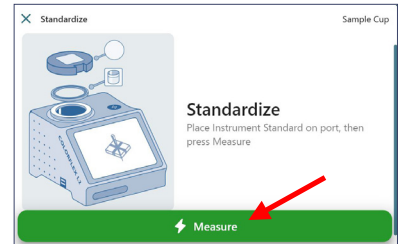

3. Remove the Instrument Standard (White Tile). Then Place the Diagnostic Check Tile (Green Tile) at the port and press **MEASURE** to continue.

- If it is the first time to run standardization with sample cup insert, Essentials will take five measurements of the green tile and use the average as the target value for future green tile checks for sample-cup-instert standardization mode on the back of the tile.
- Users can reset the green tile target for special inserts/port plates in the System Menu → Instrument Settings → Diagnostics.

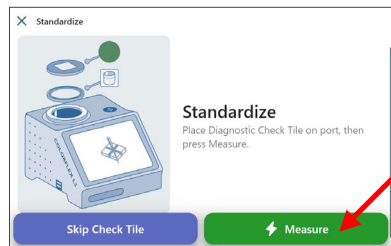

Optional: To skip the Diagnostics Check Tile test, tap **SKIP CHECK TILE**. Skipping may impact instrument performance, and a warning message will be displayed.

Note: *If the Diagnostics Check Tile fails, clean the Instrument Standard (White Tile), Diagnostic Check Tile, and/or Black Glass, and run the test again. Contact HunterLab Support if the issue persists.*

E HITCH TO TOMATO TILE

1. Choose **HITCH TO TILE** and tap **CONTINUE** button. **Hitch to Tile** refers to using a tile that has already been assigned with a reference value; **Hitch to Instrument** involves using a sample that was previously measured on the other Instrument.

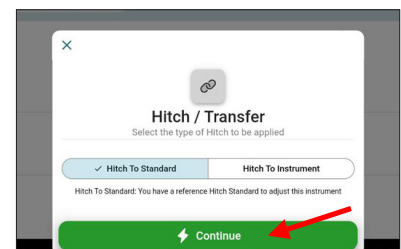

2. Place the Tomato Tile at the port and **MEASURE**.

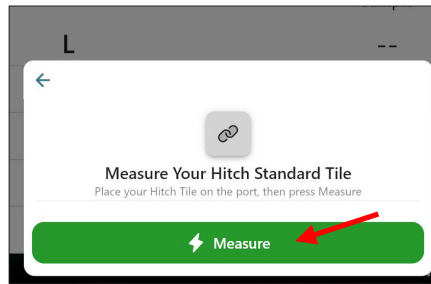

3. Enter the values of the Tomato Tile. The HunterLab Reference Standard-Tomato includes two calibrations printed on the label: NIST traceable and USDA Legacy Values.
 - Use **USDA Legacy Values** if upgrading from a porcelain-on-steel tile.
 - Use **NIST traceable values** if upgrading from a glazed ceramic tile.
 - New users should follow these rules:
 - ◇ **USDA Tomato Scores** (e.g., TPS, TSS, TCS, TJS, TDS) require USDA Legacy Values.
 - ◇ **Tomato a/b ratio + L** can use either set of values.

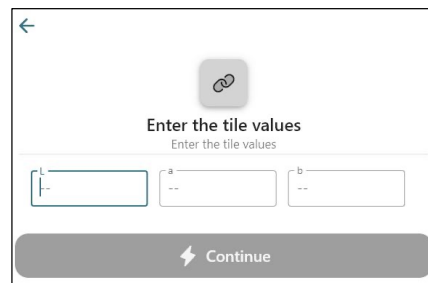

4. Select **ADDITIVE** or **RATIO** Hitch Calculations and press **CONTINUE**.

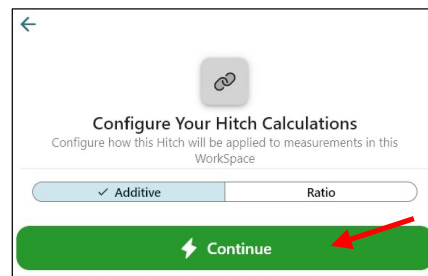

5. To update the hitch, tap Workspace name at the bottom right, select Edit Current Workspace, and then edit the hitch in Standard & Tolerances step.

Note: The Hitch Adjustment is shown on the Edit Workspace/ STANDARDS AND TOLERANCE.

F READING A SAMPLE

1. Prepare the sample and place it into the sample cup.
2. Place the sample on the port and cover the cup with the opaque cover.
3. Press **MEASURE**.

	Sample
L	20.99
a	23.55
b	11.89
TPS	43.03
Tomato a/b	1.98

G SETTING UP A STANDARD AND TOMATO INDICES

A numeric standard can be applied under Hitch/Transfer standard type.

1. Press **WORKSPACE** at the bottom right side of the screen. Select **EDIT CURRENT WORKSPACE**. Press **NEXT STEP** to go to **STANDARD & TOLERANCES** step and then enter the standard and tolerances in Hunter Lab C/2.

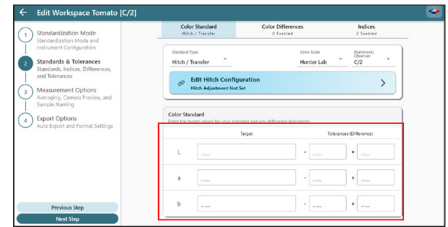

To select additional tomato indices:

2. Tap the **INDICES TAB** and then scroll down to the Tomato Scores(v). Check the desired Tomato Indices. Add tolerances using the pencil icon. Choose between Absolute or Difference Tolerances.

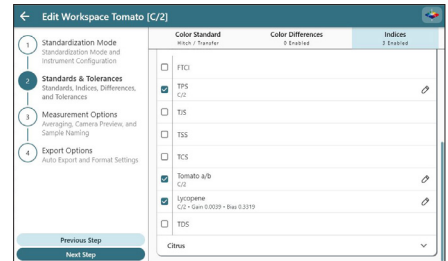

H EDITING EZ VIEW TO SHOW SIMPLE DIFFERENCES

1. From the main screen select the edit icon next to EZ View tab. Then select **DISPLAY OPTIONS**. Click on the radio button next to **SHOW STANDARD** and **SHOW DIFFERENCES** and this will display simple differences.

	Standard	Sample	Difference
L	20.85	20.95	0.10
a	23.45	23.42	-0.03
b	11.85	11.86	0.01
Tomato a/b	1.79	1.97	0.18
TPS	37.67	42.86	5.19

I CHANGING OR ADDING WORKSPACES/JOB

1. Press the **WORKSPACE** name on the bottom right side of the screen to change or add a new WorkSpace. Follow the WorkSpace dialog to edit differences/indices, read options, data export options and so on.
2. Press the **JOB** name on the bottom left side of the screen to create a new job or tap one existing job to edit job name, delete/print the job and export job (.xls, .csv or .pdf file).

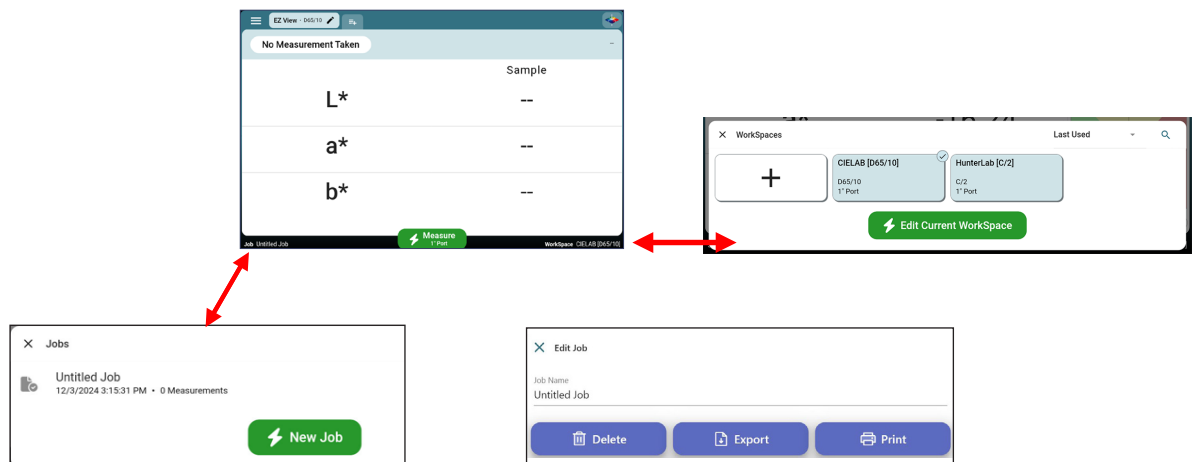

J ADDING VIEWS

1. Use the view icon  next to the EZ View tab to add other views. Select the view by clicking on the box next to the desired view. Press **SAVE**.

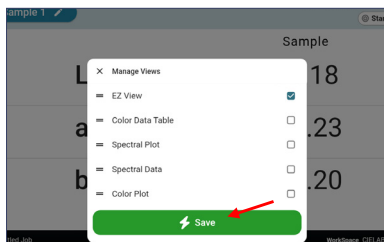

K MORE UNDER SYSTEM MENU

Tap the 3-bar icon on the top left corner of the screen to launch System Menu:

1. **Jobs/Workspaces** are alternate ways to open Workspace/Job dialogs.
2. **Instrument Settings** allows for selection of Standardization Interval, importing of product setups from the ColorFlex EZ instrument, date/time change, language selection, reverse screen orientation, and security setup.
3. **Data Management** allows users to save job and workspace files in .ezm2 format (not readable in external applications) to a flash drive.
4. **Periodic Diagnostics** displays the status of diagnostics and enable users to run diagnostics.
5. **Standardization** shows the current status and allows users to perform standardization.

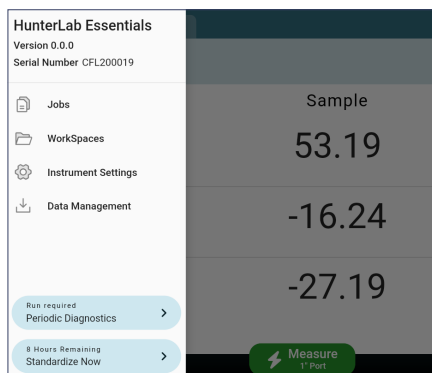

For more detailed instructions on using the instrument, please refer to the ColorFlex® L2 Tomato User's Manual. Visit support.hunterlab.com for more information on maintenance, operation and repair of your instrumentation.