

Agera[®] L2 Quick Start Guide

A60-1021-827 ver. 1.0

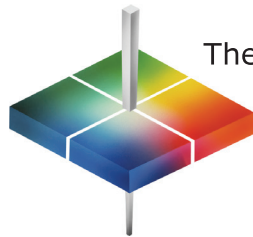

The world's true measure of color

HunterLab

A SETTING UP THE INSTRUMENT

1. Connect the plug on the AC adapter to the port on the back of the Agera L2.

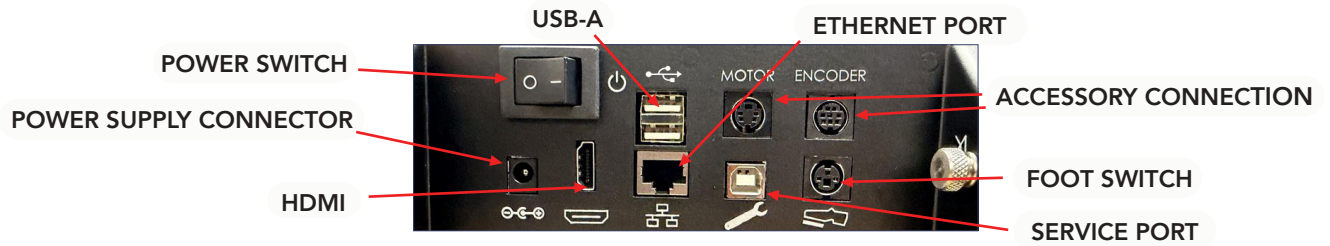

2. Plug the power cord on the AC Adapter into a wall outlet.
3. Turn on the Agera L2 using the switch on the back of the instrument.
4. The Essentials L2 software will launch automatically and prompt First Time Setup dialog to setup Languages, Region, Date and Time. Click **DONE** when finished.
5. After the setup above, a Welcome Wizard will be prompted to introduce its features. Please follow the prompts to familiarize yourself with the software. Once completed, your instrument will be ready for standardization. You can always click the HunterLab icon in the top right corner to run the Wizard again.
6. (Optional) Connect a monitor to the Agera L2 via HDMI, and a keyboard and mouse to the USB-A port.

B STANDARDIZATION

The green action button at the bottom center of the screen displays **MEASURE**. Press this button to initiate Standardization for the default Workspace settings. For more standardization options, please refer to the User's Manual for Agera L2.

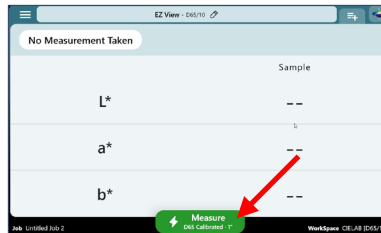

Note: Note: The gloss sensor is enabled by default and is included with every measurement.

1. Install the standard 25.4mm (1-in) port plate. Press the **STANDARDIZE** button.
2. Place the Black Glass Standard at the sensor port. Press the **MEASURE** button.

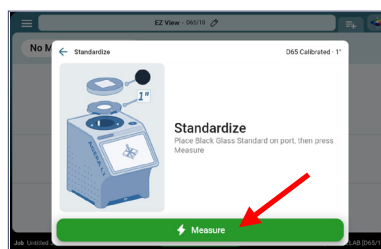

- When prompted, remove the Black Glass Standard and place the Certified Instrument Standard on the port. Press **MEASURE**.

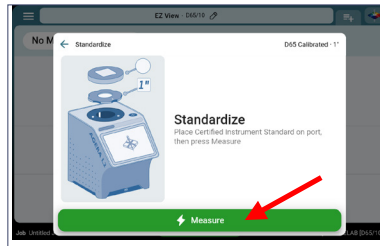

- Remove the Certified Instrument Standard. Then Place the Diagnostic Check Standard at the port and press **MEASURE** to continue. The Diagnostics Check Standard values for 1" standard port plate/Area view with D65 Calibrated are entered at the factory and listed on the back of the standard.
 - If a customer sets up other standardization mode (e.g. using different port plate, Area View, UV mode, or illuminant profile), the first special port plate standardization will take five measurements of the green standard and use the average as the target value for future green standard checks in that specific port plate standardization mode.
 - Users can reset the Diagnostic Check Standard Target for all standardization mode except 1" standard port plate/Area view with D65 Calibrated in the System Menu → Instrument Settings → Diagnostics.

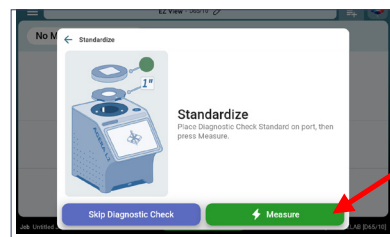

Optional: To skip the Diagnostics Check Standard test, tap **SKIP DIAGNOSTIC CHECK**. Skipping may impact instrument performance, and a warning message will be displayed.

Note: If the Diagnostics Check Standard fails, clean the Certified Instrument Standard, Diagnostic Check Standard, and/or Black Glass Standard, and run the test again. Contact HunterLab Support if the issue persists.

C READING SAMPLES

- Prepare the sample and center it on the port. Press **MEASURE**.

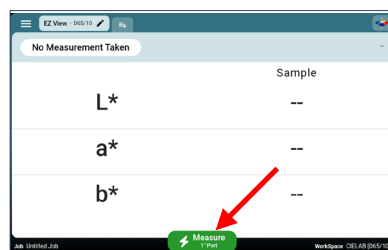

When a new instrument is turned on, it loads with the following default Workspace:

Display: EZ View
Color Scale: CIELAB Absolute
Ill/Observer: D65/10-degree
Standard Type: Ad hoc/Working

Note: There are two default WorkSpaces loaded, CIELAB (D65/10) and HunterLab (C/2). These WorkSpaces cannot be modified. However, you can edit a default Workspace and save it as a new one or create a new Workspace based on the existing one and then edit there.

D CREATING A STANDARD

1. In the default WorkSpace (Ad hoc/Working standard type), the first sample reading is automatically set as the standard. To change it, read a new sample, click the pencil icon in the Sample Name box, and select **Set as Standard**.

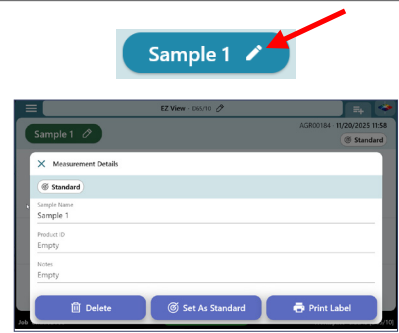

E EDITING THE EZ VIEW TO SHOW SIMPLE DIFFERENCES

1. From the EZ View screen, select the edit icon  in the EZ View tab. Then select **DISPLAY OPTIONS**. Select the radio button next to **SHOW STANDARD** and **SHOW DIFFERENCES** and this will display simple differences.

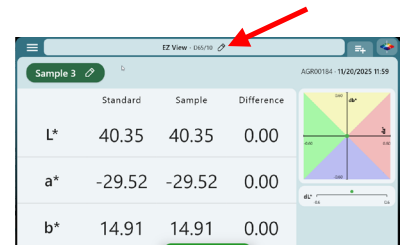

F EDITING THE COLOR SCALE IN THE EZ VIEW

1. From the EZ View screen, select the edit icon  in the EZ View tab. Then select the color scale needed.

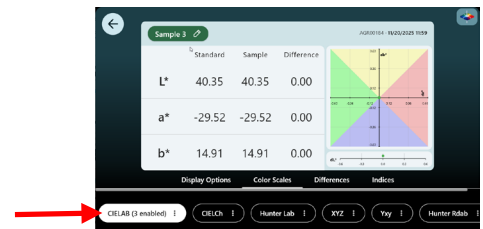

G CHANGING OR ADDING WORKSPACES/JOB

1. Press the **WORKSPACE** name on the bottom right side of the screen to change or add a new WorkSpace. Follow the WorkSpace dialog to edit differences/indices, read options, data export options and so on.
2. Press the **JOB** name on the bottom left side of the screen to create a new job or tap one existing job to edit job name, delete/print the job and export job (.xls, .csv or .pdf file).

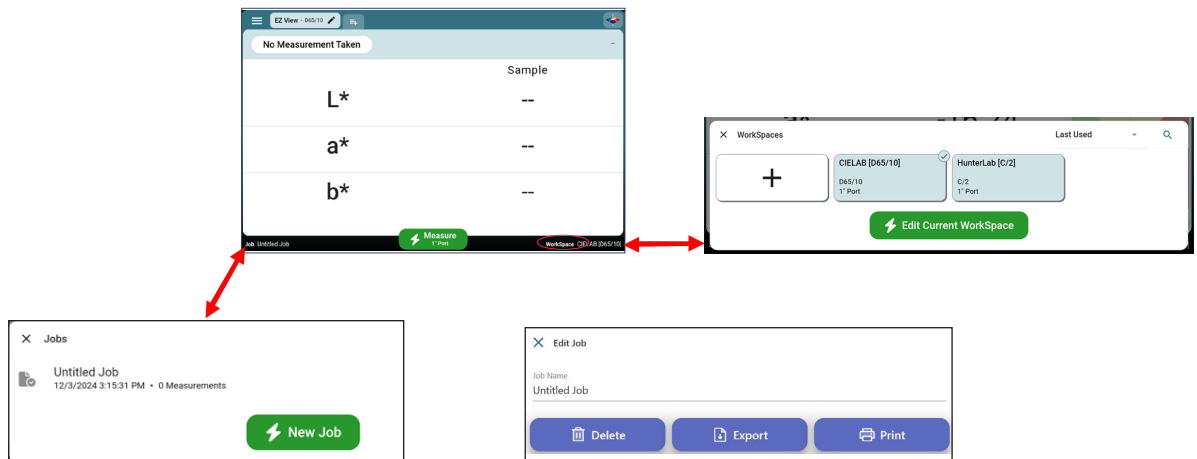

H**ADDING VIEWS**

1. Use the view icon  next to the EZ View tab to add other views. Select the view by clicking on the box next to the desired view. Press **SAVE**.

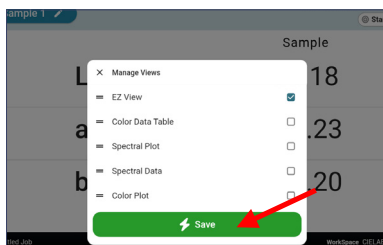
**I****MORE UNDER SYSTEM MENU**

Tap the 3-bar icon on the top left corner of the screen to launch System Menu:

1. **Jobs/Workspaces** are alternate ways to open WorkSpace/Job dialogs.
2. **Instrument Settings** allows for selection of Standardization Interval, importing of standards from the Agera instrument, date/time change, language selection, reverse screen orientation, and security setup.
3. **Data Management** allows users to save job and workspace files in .ezm2 format (not readable in external applications) to a flash drive.
4. **Periodic Diagnostics** displays the status of diagnostics and enable users to run diagnostics.
5. **Standardization** shows the current status and allows users to perform standardization.

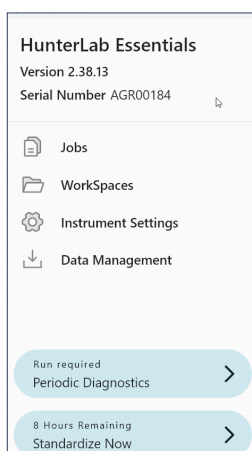

For more detailed instructions on using the instrument, please refer to the User's Manual for Agera L2. Visit support.hunterlab.com for more information on maintenance, operation and repair of your instrumentation.